

DOE-ID NEPA CX DETERMINATION Idaho National Laboratory

SECTION A. Project Title: MFC Administrative Building

SECTION B. Project Description and Purpose:

The scope of this revision covers construction and operation of a one-story Materials and Fuels Complex (MFC) Administration Building having about 19,000 to 22,000 gross sq ft of building space. The proposed facility includes offices, administrative support spaces, and a cafeteria where dining hall space also serves as a meeting and training center. The cafeteria serves the entire MFC workforce and the associated dining area includes break-out meeting spaces and features to allow large gatherings. Laboratory space is not included in the facility scope, and radiological work will not be conducted in the building.

The building will be constructed south of building MFC-752 and west of MFC-701 inside the MFC security perimeter (See Figure 1). Building utilities (electrical power, sewer, fire and potable water, and fiber optic cable) will be distributed from existing MFC utilities. Sewer will be routed from the building to the existing man hole SN-08. Water will be distributed to the building from a water line east of MFC-701. Electrical power will be distributed to the building from the MFC-710 substation. Fiber optic cable for communications will be distributed from the MFC-1728 dial room. Construction of the building requires removal of the inner security fence between the access road south of MFC-701 and the north end of MFC-701. A new inner security fence will be constructed to connect the access road fence to the south end of MFC-701.

Figure 1. Preliminary Site Plan for the Proposed MFC Administrative Building

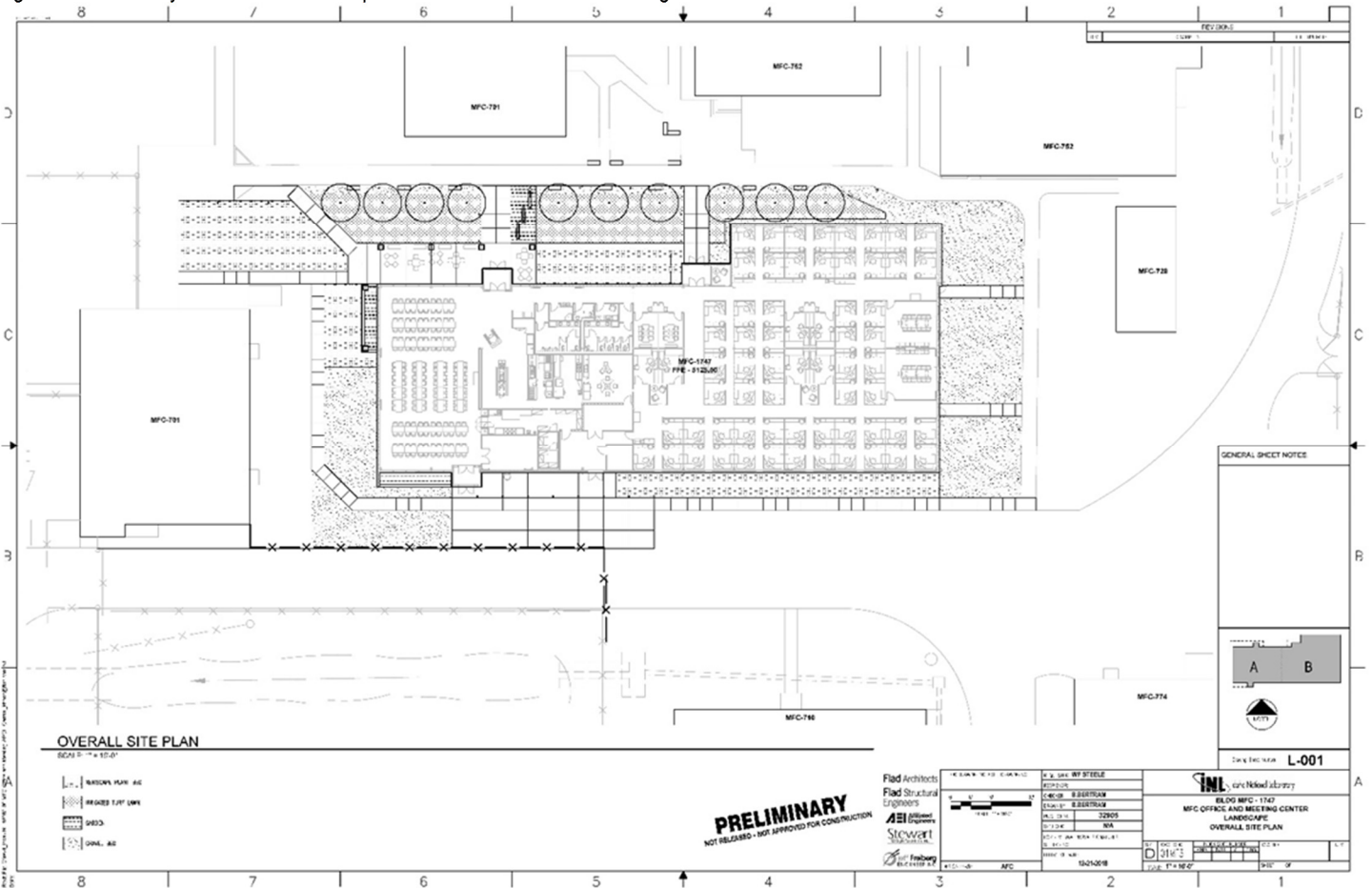

The building will be designed and constructed to meet the provisions of the Guiding Principles for Federal Leadership in High Performance and Sustainable Buildings per Executive Order 13834 Efficient Federal Operations, 42 U.S.C. § 6834: Federal Building Energy Efficiency Standards, 42 U.S.C. § 8253: Energy Management Requirements, 42 U.S.C. § 17092: High-Performance Green Federal Buildings, and 42 U.S.C. § 8259b: Federal Procurement of Energy Efficient Products; et.al.

SECTION C. Environmental Aspects or Potential Sources of Impact:

Air Emissions

Activities addressed by this EC have the potential to contribute to air emissions through:

- Generating air pollutants, including but not limited to chemical and combustion emissions

DOE-ID NEPA CX DETERMINATION

Idaho National Laboratory

- Generating hazardous emissions, such as by operation of fuel burning equipment, use of construction or maintenance products that contain hazardous constituents, and disturbance of contaminated soils
- Maintaining, servicing or repairing stationary heating, ventilation, air conditioning and refrigeration equipment
- Maintaining, testing, or disposing of halon-containing equipment or halon
- Acquiring and dispositioning chemicals
- Generating fugitive dust or other fugitive emissions
- Purchasing, relocating, operating, modifying or maintaining portable air emission sources, including non-road internal combustion engines.

Discharging to Surface-, Storm-, or Ground Water

Activities addressed by this EC have the potential to contaminate waters of the United States (U.S.) or groundwater through:

- Construction or modification of drinking water systems and cross connections
- Maintaining, repairing, or altering drinking water systems and cross connections
- Using drinking water systems and cross connections
- Constructing or modifying sewage and other reuse systems
- Discharging Wastewaters
- Managing storm water discharges.

Disturbing Cultural or Biological Resources

Activities addressed by this EC have the potential to disturb cultural or biological resources through:

- Constructing or modifying facilities, structures, equipment or processes.

Generating and Managing Waste

Activities addressed by this EC have the potential to generate waste requiring management through:

- Generating wastes.

Releasing Contaminants

Typical construction chemicals such as fuels, lubricants, adhesives, paints, concrete, concrete cure, asphalt, refrigerants, etc., will be used and will be submitted to chemical inventory lists with associated Safety Data Sheets (SDSs) for approval in the vendor data system prior to use. The facility Chemical Coordinator will enter these chemicals into the INL Chemical Management Database. All chemicals will be managed in accordance with laboratory procedures. When dispositioning surplus chemicals, project personnel must contact the facility Chemical Coordinator for disposition instructions.

Although not anticipated, there is a potential for spills when using chemicals or fueling equipment. In the event of a spill, notify facility PEL. If the PEL cannot be contacted, report the release to the Spill Notification Team (208-241-6400). Clean up the spill and turn over spill cleanup materials to WGS.

Using, Reusing, and Conserving Natural Resources

Activities addressed by this EC have the potential for use, reuse and conservation of natural resources related to:

- Building energy use
- Consuming potable or industrial water
- Generating landfill waste or construction and demolition wastes
- Generating recyclable materials
- Providing an opportunity to engage in sustainable acquisition practices.

SECTION D. Determine Recommended Level of Environmental Review, Identify Reference(s), and State Justification: Identify the applicable categorical exclusion from 10 Code of Federal Regulation (CFR) 1021, Appendix B, give the appropriate justification, and the approval date.

For Categorical Exclusions (CXs), the proposed action must not: (1) threaten a violation of applicable statutory, regulatory, or permit requirements for environmental, safety, and health, or similar requirements of Department of Energy (DOE) or Executive Orders; (2) require siting and construction or major expansion of waste storage, disposal, recovery, or treatment or facilities; (3) disturb hazardous substances, pollutants, contaminants, or Comprehensive Environmental Response, Compensation, and Liability Act (CERCLA)-excluded petroleum and natural gas products that pre-exist in the environment such that there would be uncontrolled or unpermitted releases; (4) have the potential to cause significant impacts on environmentally sensitive resources (see 10 CFR 1021). In addition, no extraordinary circumstances related to the proposal exist that would affect the significance of the action. In addition, the action is not

DOE-ID NEPA CX DETERMINATION
Idaho National Laboratory

“connected” to other action actions (40 CFR 1508.25(a)(1) and is not related to other actions with individually insignificant but cumulatively significant impacts (40 CFR 1608.27(b)(7)).

References: 10 CFR 1021, Appendix B to Subpart D, items B1.15 "Support buildings"

Justification: Project activities described in this Environmental Checklist (EC) are consistent with 10 CFR 1021, Appendix B to Subpart D, items B1.15 "Siting, construction or modification, and operation of support buildings and support structures (including, but not limited to, trailers and prefabricated and modular buildings) within or contiguous to an already developed area (where active utilities and currently used roads are readily accessible). Covered support buildings and structures include, but are not limited to, those for office purposes; parking; cafeteria services; education and training; visitor reception; computer and data processing services; health services or recreation activities; routine maintenance activities; storage of supplies and equipment for administrative services and routine maintenance activities; security (such as security posts); fire protection; small-scale fabrication (such as machine shop activities), assembly, and testing of non-nuclear equipment or components; and similar support purposes, but exclude facilities for nuclear weapons activities and waste storage activities covered in B1.10, B1.29, B1.35, B2.6, B6.2, B6.5, B6.6, and B6.10 of this appendix."

Is the project funded by the American Recovery and Reinvestment Act of 2009 (Recovery Act) Yes No

Approved by Jason Sturm, DOE-ID NEPA Compliance Officer on: 1/28/2019