

DOE-ID NEPA CX DETERMINATION  
Idaho National Laboratory

**SECTION A. Project Title:** Test Reactor Area (TRA)-670 New Window in Advanced Test Reactor (ATR) Production Control Center

**SECTION B. Project Description and Purpose:**

The window in the Production Control Center (PCC) at the Advanced Test Reactor (ATR), building TRA-670, is not operational and a new, functional window is needed. The proposed action would construct a new window to the PCC. The activity would require block removal for installation of a framed opening on the south wall. The new opening would be approximately 39 in. X 32 in. and constructed on a non-load bearing wall (see Figure 1). The opening would be framed with finished wood and finished. Glass would not be installed in the new opening.

Figure 1. View of location for proposed new window

**New Opening Between Room 101 and Corridor 102**

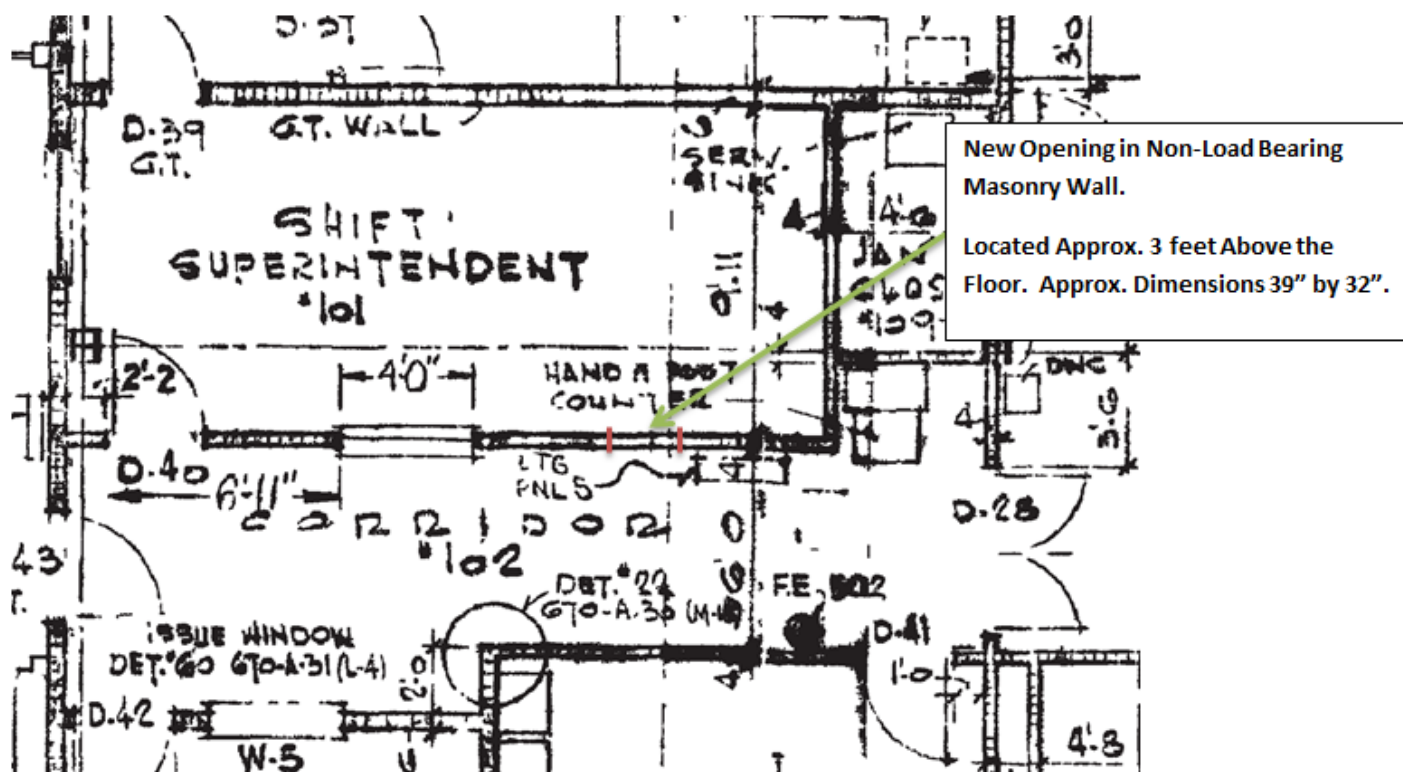

Illustration – Partial plan view of TRA-670, first floor entryway area.

**SECTION C. Environmental Aspects or Potential Sources of Impact:**

**Air Emissions**

Maintenance activities could generate fugitive dust.

Project activities have the potential to disturb asbestos containing building materials.

**Disturbing Cultural or Biological Resources**

TRA-670 is eligible for nomination to the National Register of Historic Places and is considered a Category 1 historic property. Removal and/or changes of original features may adversely impact this historic property. Prior to beginning work, obtain cultural/historical resource review by contacting Christina Olson (526-1692). Approval must be demonstrated by written communication from this organization prior to beginning work, and any instructions contained in the review must be followed.

# DOE-ID NEPA CX DETERMINATION

## Idaho National Laboratory

### Generating and Managing Waste

Maintenance activities may generate a variety of waste. It is anticipated that the following types of waste could be generated:

- Industrial (non-hazardous, non-radioactive) waste including typical maintenance wastes such as boxes, wood, wiring, paper, insulation, and some metals.
- Hazardous wastes could be generated during project activities on systems or equipment containing hazardous chemicals, or by using hazardous chemicals to clean or decontaminate equipment and systems. Hazardous metal waste (e.g., lead, electronics, brass, metal containing paints, etc.) may also be generated during the project or by replacement of outdated equipment. Note: Lead has been encountered very infrequently (e.g., shielded cables).
- Asbestos waste may be generated when performing activities on equipment or structures with asbestos-containing materials (ACM) such as insulation, gaskets, flanges, walls, roofing, and flooring.
- Polychlorinated Biphenyl (PCB) waste could be generated when performing activities associated with pre-1982 equipment/materials such as capacitors, lubricants/dielectric fluids, transformers/bushings, painted surfaces and other electrical equipment/components.

### Releasing Contaminants

Construction chemicals such as paint, fuels, lubricants, adhesives, etc., will be used during the project. There is the potential to release small amounts of contaminants to the environment during project activities.

### Using, Reusing, and Conserving Natural Resources

All materials would be reused and/or recycled where economically practicable. All applicable waste would be diverted from disposal in the landfill where conditions allow. The project would practice sustainable acquisition.

<b>SECTION D. Determine Recommended Level of Environmental Review, Identify Reference(s), and State Justification:</b> Identify the applicable categorical exclusion from 10 Code of Federal Regulation (CFR) 1021, Appendix B, give the appropriate justification, and the approval date
-------------------------------------------------------------------------------------------------------------------------------------------------------------------------------------------------------------------------------------------------------------------------------------------

For Categorical Exclusions (CXs), the proposed action must not: (1) threaten a violation of applicable statutory, regulatory, or permit requirements for environmental, safety, and health, or similar requirements of Department of Energy (DOE) or Executive Orders; (2) require siting and construction or major expansion of waste storage, disposal, recovery, or treatment or facilities; (3) disturb hazardous substances, pollutants, contaminants, or Comprehensive Environmental Response, Compensation, and Liability Act (CERCLA)-excluded petroleum and natural gas products that pre-exist in the environment such that there would be uncontrolled or unpermitted releases; (4) have the potential to cause significant impacts on environmentally sensitive resources (see 10 CFR 1021). In addition, no extraordinary circumstances related to the proposal exist that would affect the significance of the action. In addition, the action is not "connected" to other action actions (40 CFR 1508.25(a)(1) and is not related to other actions with individually insignificant but cumulatively significant impacts (40 CFR 1608.27(b)(7)).

**References:** 10 CFR 1021, Appendix B2.1 "Workplace enhancements"

**Justification:** Activities are consistent with 10 CFR 1021, Appendix B2.1 "Modifications within or contiguous to an existing structure, in a previously disturbed or developed area, to enhance workplace habitability (including, but not limited to, installation or improvements to lighting, ... or heating/ventilation/air conditioning and its instrumentation, and noise reduction)."

Is the project funded by the American Recovery and Reinvestment Act of 2009 (Recovery Act)  Yes  No

Approved by Jack Depperschmidt, DOE-ID NEPA Compliance Officer on: 7/12/2016