

**DOE-ID NEPA CX DETERMINATION  
Idaho National Laboratory**

**SECTION A. Project Title: MFC-768 D&D for Mock-up Relocation**

**SECTION B. Project Description and Purpose:**

The scope of this task is to relocate the machining capability of the Materials and Fuels Complex (MFC) Mock-Up Shop from MFC-765 Fuel Conditioning Facility (FCF) to MFC-768 Power Plant Building. This task requires demolition at the planned new location for the machining capability, supporting facility modifications, and installation of machining equipment, both new Government Furnished Equipment (GFE) and reused equipment. Supporting facility modifications include providing a conference room / breakroom and office area with appropriate amenities and supplying all necessary utilities for the machine tooling. Although most systems and components located within the planned demolition area are already retired, there remain several in-service systems. These in-service systems, such as the Purified Water Distribution System, Potable Water System, and Fire Water System will be reconfigured as necessary to maximize free space available for the relocated machining capability.

Relocation of the Mock-Up Shop machining capability will allow for future expanded FCF function that fits within the scope of the facility's Nuclear Facility Status. The Mock-Up Shop itself, and the activities carried out within, are not Nuclear Facility Function related with respect to regulatory requirements. Therefore, the machining capability does not warrant location within a Nuclear Facility to accomplish its mission. Existing machining capability will be retained with specific improvements as delineated herein.

**DEMOLITION**

During demolition, regulated materials such as lead paint and asbestos insulation are expected. All above grade systems and components, items, and materials, located in the First Floor Water Treating Area and Mezzanine level at the southwest region of Building MFC-768 Power Plant, within the volume bounded by structural columns A-1, A-5, B-1, and B-5 shall be removed, subject to clarifications listed in Table 1. (Refer to Figure 1 and Figure 2 for demolition area.)

**DOE-ID NEPA CX DETERMINATION  
Idaho National Laboratory**

Table 1. Demolition clarifications

Item No.	Clarification	Description
1.	Do not disturb	Building structural members, such as columns, girts, and weldments
2.	Replace	Life safety system components such as smoke detectors and horn strobes
3.	Replace and Reconfigure	Fire water sprinkler supply piping and sprinkler heads (refer to Subsection 2.3.1)
4.	Plug	Floor drains
5.	Do not remove	Roof drain pipes
6.	Do not remove	Roof drain pipes heat-trace tapes
7.	Do not remove	Purified Water Tank PD-TK-255 drain, recirculation, and overflow piping
8.	Remove	Lighting fixtures
9.	Replace	Steam unit heater attached to south wall
10.	Remove	Ladder to mezzanine
11.	Remove	Concrete equipment pads and curbing flush with floor
12.	Remove	All equipment, conduit, and piping supports that will no longer be used
13.	Remove	Existing first floor ventilation fan through west exterior wall
14.	Remove	Caustic tank and associated piping on the mezzanine
15.	Remove	Retired components located under and immediately south of stairway from the First Floor to Mezzanine level
16.	Remove	Mezzanine level exhaust fans
17.	Replace	South overhead roll-up exterior door No. 102 adjacent to structural column C-5
18.	Remove	Retired components located in pipe trenches
19.	Remove	First floor Safety Shower
20.	Do not disturb	Private Facility Control Network (PFCN) system
21.	Relocate	Auxiliary Cooling Tower fan temperature indicating controllers (Chessell digital panel meters P7-TIC-675C and P7-TIC-675D)
22.	Do not remove	Main condenser cooling water piping located north of crane area

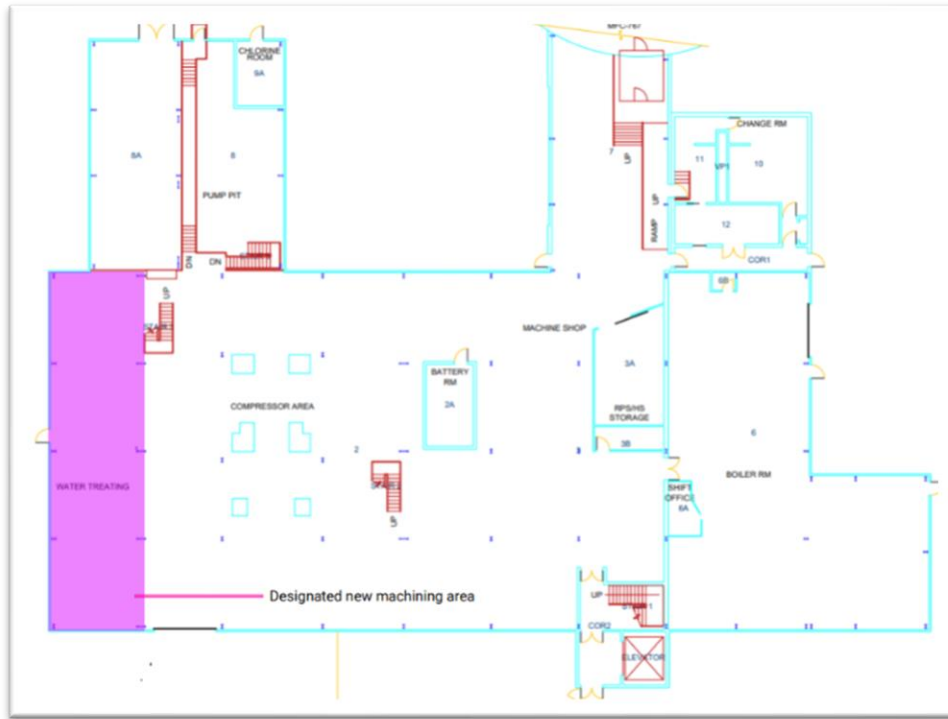

Figure 1. MFC-768 first floor

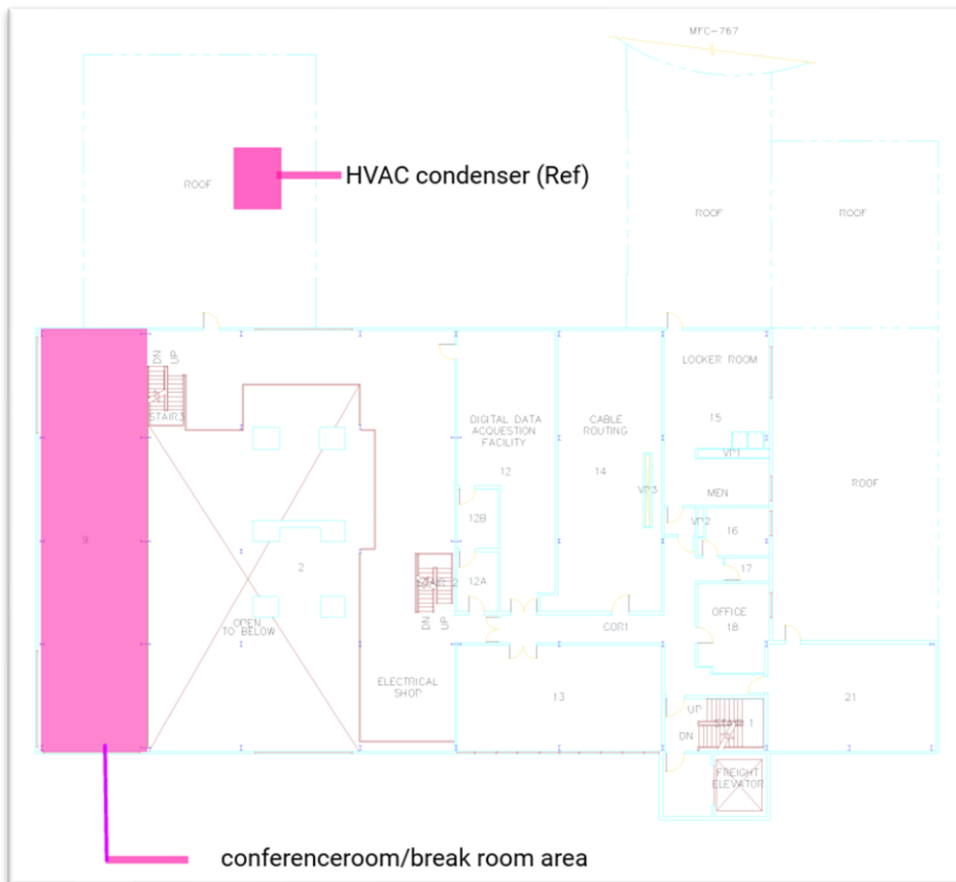

Figure 2. MFC-768 mezzanine level.

# DOE-ID NEPA CX DETERMINATION

## Idaho National Laboratory

The Water Treating Area and Mezzanine level have been designated as the new MFC Mock-Up Shop machining capability location and associated conference room/breakroom and office area, respectively. Following demolition, repairs will be made to old equipment pads, and any curb will be removed. Self-leveling epoxy will be applied to repair flooring flush and concrete will be painted/coated. Modifications to MFC-768 will be made to accommodate for shop layout, machine tool capabilities, remote handling system capabilities, assembly/testing area capabilities, shop utilities, and office space

### **SECTION C. Environmental Aspects or Potential Sources of Impact:**

#### **Air Emissions**

N/A

#### **Discharging to Surface-, Storm-, or Ground Water**

N/A

#### **Disturbing Cultural or Biological Resources**

There is the potential for this work to impact vegetation and for project personnel to interact with various wildlife species. A Biological Resource Review will be arranged within two weeks prior to the initiation of any activities that might disturb soil or vegetation and again following completion of project activities. A nesting bird survey is included with the Biological Resource Review for actions occurring between April 1 - October 1 per compliance with the Migratory Bird Treaty Act. Bat surveys are also included with the Biological Resource Review in accordance with the INL Bat Protection Plan.

A Section 106 review was completed under CRMO project number (BEA-24-033) and resulted in an adverse effect finding. Idaho SHPO and/or Tribes (as applicable) concurred with this finding on 20 May 2024. A Memorandum of Agreement (MOA), (NE700161) was executed by DOEID and Idaho SHPO on 26 August 2024. Please refer to Hold Points and Project Specific Instructions within the ECP for more information.

#### **Generating and Managing Waste**

When wastes are generated, how they are disposed can adversely affect the environment. Managing wastes appropriately and responsibly and implementing recycling or reuse practices, where feasible, during project activities can reduce the potential impact on the environment.

Polychlorinated Biphenyl (PCB) waste could be generated when performing maintenance on, replacing, or performing D&D on equipment manufactured before 1982. Such equipment and associated materials include but are not limited to capacitors, lubricants/dielectric fluids, transformers and bushings, light fixtures, electric motors, pumps, voltage regulators, other equipment/components that contain oil, and oil associated with electrical conduit/cable.

Polychlorinated Biphenyl (PCB) waste could be generated when work activities involve structures or buildings built before 1982 (e.g., painted surfaces, caulking, adhesives, rubber gaskets, joint sealer, cable/wire insulation, ventilation duct gaskets or insulation).

#### **Releasing Contaminants**

When chemicals are used during the project there is the potential for spills that could impact the environment (air, water, soil).

#### **Using, Reusing, and Conserving Natural Resources**

Project description indicates materials will need to be purchased or used that require sourcing materials from the environment. Being conscientious about the types of materials used could reduce the impact to our natural resources.

#### **Environmental Justice**

According to the CEQ Climate and Economic Justice Screening Tool, the INL site as well as the Research and Education Campus in Idaho Falls, ID are located in U.S. Census tracts that are identified as disadvantaged communities. Census tracts identified as disadvantaged meet or exceed socioeconomic, environmental, health, or demographic thresholds identified by CEQ. Given that activities analyzed in this document will happen within the boundaries of existing DOE/INL land and/or facilities where there are no permanent residents, any impacts to Environmental Justice in surrounding communities are anticipated to be negligible.

**DOE-ID NEPA CX DETERMINATION**  
**Idaho National Laboratory**

**SECTION D. Determine Recommended Level of Environmental Review, Identify Reference(s), and State Justification:** Identify the applicable categorical exclusion from 10 Code of Federal Regulation (CFR) 1021, Appendix B, give the appropriate justification, and the approval date.

For Categorical Exclusions (CXs), the proposed action must not: (1) threaten a violation of applicable statutory, regulatory, or permit requirements for environmental, safety, and health, or similar requirements of Department of Energy (DOE) or Executive Orders; (2) require siting and construction or major expansion of waste storage, disposal, recovery, or treatment or facilities; (3) disturb hazardous substances, pollutants, contaminants, or Comprehensive Environmental Response, Compensation, and Liability Act (CERCLA)-excluded petroleum and natural gas products that pre-exist in the environment such that there would be uncontrolled or unpermitted releases; (4) have the potential to cause significant impacts on environmentally sensitive resources (see 10 CFR 1021). In addition, no extraordinary circumstances related to the proposal exist that would affect the significance of the action. In addition, the action is not "connected" to other action actions (40 CFR 1508.25(a)(1) and is not related to other actions with individually insignificant but cumulatively significant impacts (40 CFR 1608.27(b)(7)).

**References:** B1.15 "Support buildings", B1.31 "Installation or relocation of machinery and equipment"

**Justification:** Based on the purpose and need and description of the proposed action and potential environmental impacts, the proposed action fits within the class of actions that is listed in Appendix B CX B1.15 and B1.31. There are no extraordinary circumstances related to the proposed action that may affect the significance of the environmental effects of the proposal. The proposed action has not been segmented to meet the definition of a categorical exclusion. This proposal is not connected to other actions with potentially significant impacts (40 CFR 1508.25(a)(1)), is not related to other actions with individually insignificant but cumulatively significant impacts (40 CFR 1508.27(b)(7)) and is not precluded by 40 CFR 1506.1 or 10 CFR 1021.211 concerning limitations on actions during preparation of an environmental impact statement.

Authorizing the proposed action will not (1) threaten a violation of applicable statutory, regulatory, or permit requirements for environment, safety, and health, including DOE and/or Executive orders; (2) require siting of new facilities or expansion of existing facilities; (3) disturb hazardous substances, pollutants, or contaminants; (4) adversely affect environmentally sensitive resources; or (5) involve genetically engineered organisms, synthetic biology, governmentally designated noxious weeds, or invasive species.

B1.15 Siting, construction or modification, and operation of support buildings and support structures (including, but not limited to, trailers and prefabricated and modular buildings) within or contiguous to an already developed area (where active utilities and currently used roads are readily accessible). Covered support buildings and structures include, but are not limited to, those for office purposes; parking; cafeteria services; education and training; visitor reception; computer and data processing services; health services or recreation activities; routine maintenance activities; storage of supplies and equipment for administrative services and routine maintenance activities; security (such as security posts); fire protection; small-scale fabrication (such as machine shop activities), assembly, and testing of non-nuclear equipment or components; and similar support purposes, but exclude facilities for nuclear weapons activities and waste storage activities, such as activities covered in B1.10, B1.29, B1.35, B2.6, B6.2, B6.4, B6.5, B6.6, and B6.10 of this appendix.

B1.31 Installation or relocation and operation of machinery and equipment (including, but not limited to, laboratory equipment, electronic hardware, manufacturing machinery, maintenance equipment, and health and safety equipment), provided that uses of the installed or relocated items are consistent with the general missions of the receiving structure. Covered actions include modifications to an existing building, within or contiguous to a previously disturbed or developed area, that are necessary for equipment installation and relocation. Such modifications would not appreciably increase the footprint or height of the existing building or have the potential to cause significant changes to the type and magnitude of environmental impacts.

Is the project funded by the American Recovery and Reinvestment Act of 2009 (Recovery Act)     Yes     No

Approved by Robert Douglas Herzog, DOE-ID NEPA Compliance Officer on: 1/21/2025